

How to Use this Guide:

1. Begin by filling in the dimensions on the site plan. Please include any other structures that are on the property. This will verify that the required set backs of the City of Avondale Zoning Ordinance are met.
2. Fill in all the blanks on the patio design form with the sizes and types of material that are being utilized. If there are items of which you are unsure; the Building Staff will be able to explain and assist you.
3. Please be prepared to provide home owner information such as property parcel number, address, owner name, and owner phone number.
4. Having these forms completely filled out will assist City of Avondale Development Services Department Staff in verifying the conformance of the project and processing your request quickly. Some permits will require additional time for review by staff.

If you have any questions or concerns please contact the Development Services Department Staff at 623-333-4000 and someone will be glad to assist you.

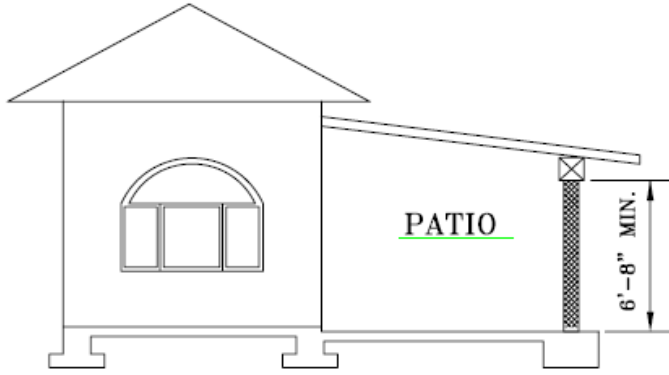

ELEVATION VIEW

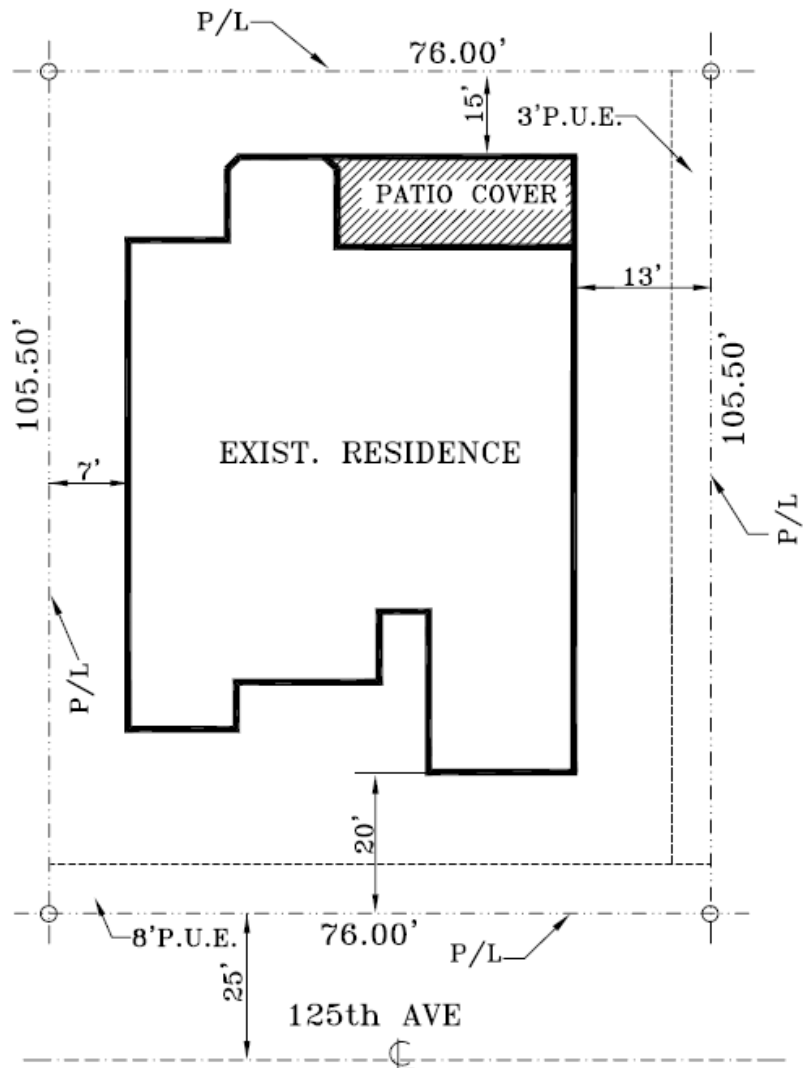

ADDRESS:

NOTE: THIS PLOT PLAN IS NOT TO SCALE.
EASEMENT, PROPERTY LINES, BUILDING SETBACKS,
ARE TO BE USED AS AN EXAMPLE ONLY.

Development & Engineering Services Department

11465 W. Civic Center Drive, #110, Avondale, AZ 85323 • Phone (623) 333-4000 • Fax (623) 333-0402 • TDD (623) 333-0010
www.avondaleaz.gov/developmentservices

SPECIFICATIONS FOR
PATIO COVER

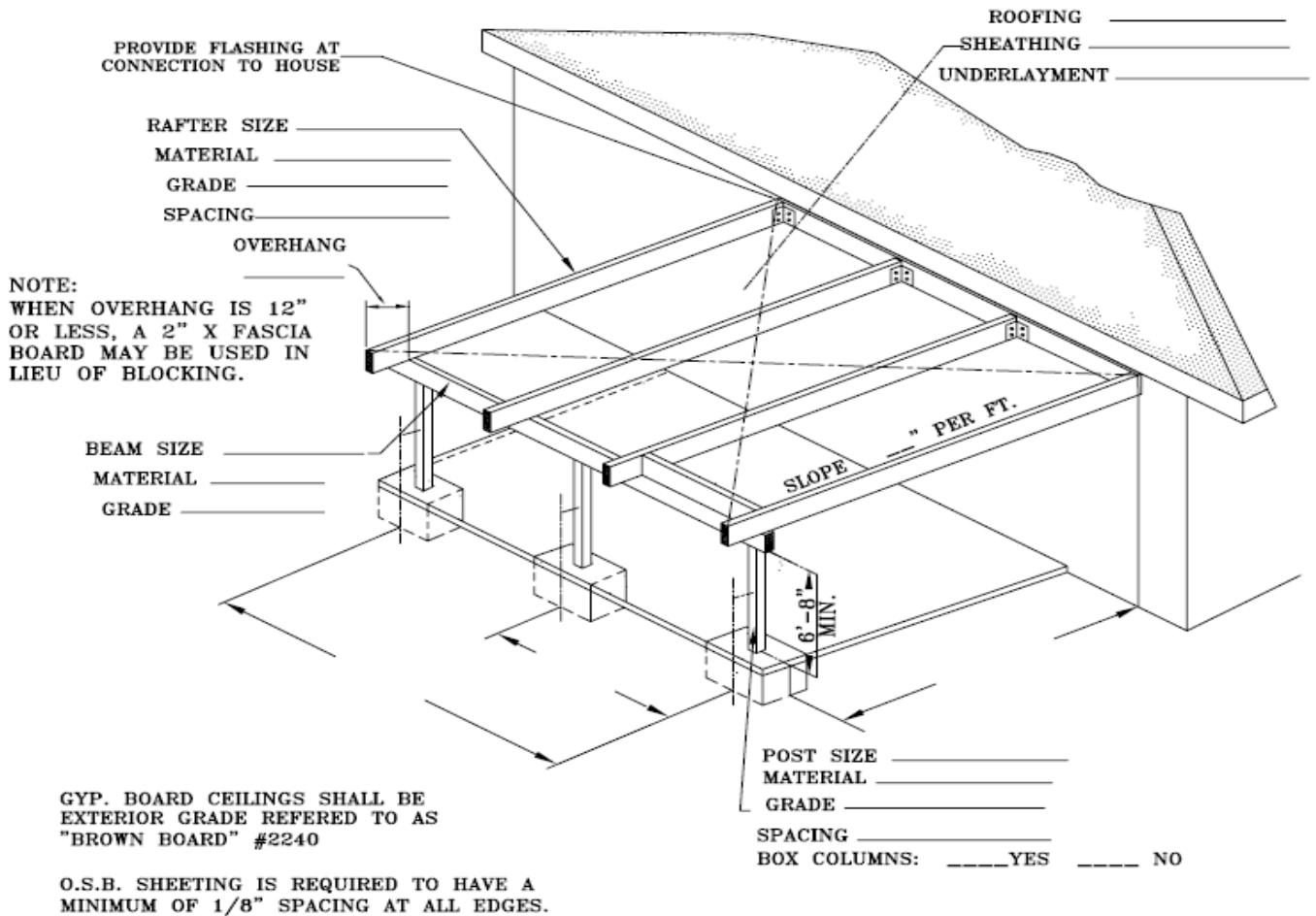

Minimum Beam Sizes (Inches)								
Post Spacing (ft)	Rafter spans (ft)							
	6	8	10	12	14	16	18	20
4	4x4	4x4	4x4	4x4	4x4	4x4	4x4	4x6
6	4x4	4x4	4x6	4x6	4x6	4x6	4x6	4x6
8	4x6	4x6	4x6	4x6	4x8	4x8	4x8	4x8
10	4x6	4x8	4x8	4x8	4x10	4x10	4x10	4x10
12	4x8	4x8	4x10	4x10	4x10	4x12	4x12	4x12
14	4x8	4x10	4x10	4x12	4x12	4x12	4x14	4x14
16	4x10	4x10	4x12	4x12	4x14	4x14	4x16	4x16
18	4x10	4x12	4x14	4x14	4x16	4x16	4x16	4x16
20	4x12	4x14	4x14	4x16	4x16	4x18	4x18	4x18

Minimum Rafter sizes (inches)			
RAFTER SPAN(ft)	Rafter spacing (center to center)		
	12	16	24
10	2x6	2x6	2x6
11	2x6	2x6	2x8
12	2x6	2x6	2x8
13	2x6	2x8	2x8
14	2x6	2x8	2x10
15	2x8	2x8	2x10
16	2x8	2x8	2x10
17	2x8	2x10	2x10
18	2x8	2x10	2x12
19	2x8	2x10	2x12
20	2x10	2x10	2x12

Development & Engineering Services Department

11465 W. Civic Center Drive, #110, Avondale, AZ 85323 • Phone (623) 333-4000 • Fax (623) 333-0402 • TDD (623) 333-0010

www.avondaleaz.gov/developmentservices

SPECIFICATIONS FOR
PATIO COVER

NOTE:
O.S.B. SHEETING IS REQUIRED TO HAVE A
MINIMUM OF 1/8" SPACING AT ALL EDGES

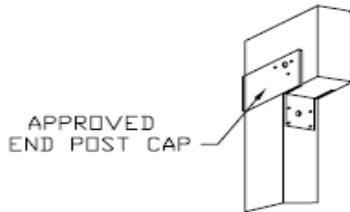

APPROVED
END POST CAP

1 END POST AND BEAM

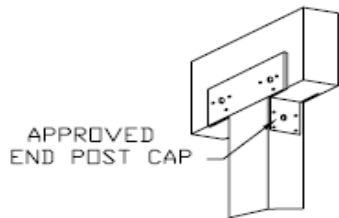

APPROVED
END POST CAP

2 POST AND BEAM

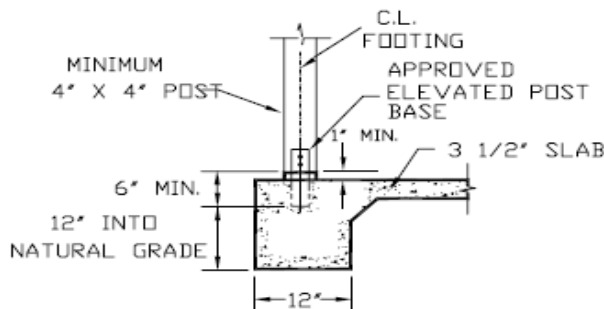

3 FOOTING DETAIL

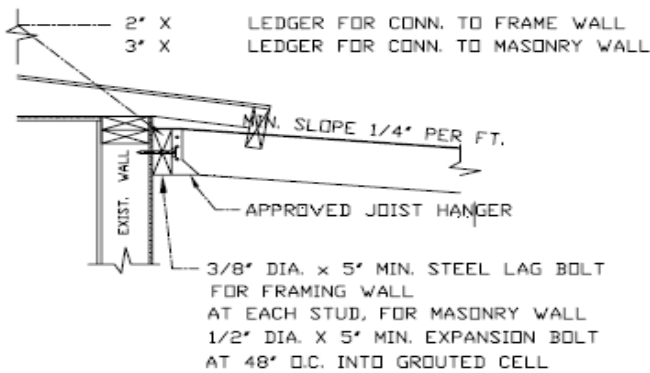

4 LEDGER TO FRAME WALL
LEDGER TO MASONRY WALL

NOTE:
REMOVE STUCCO, LATHE AND FOAM FOR
WOOD TO WOOD CONNECTION AT LEDGER.

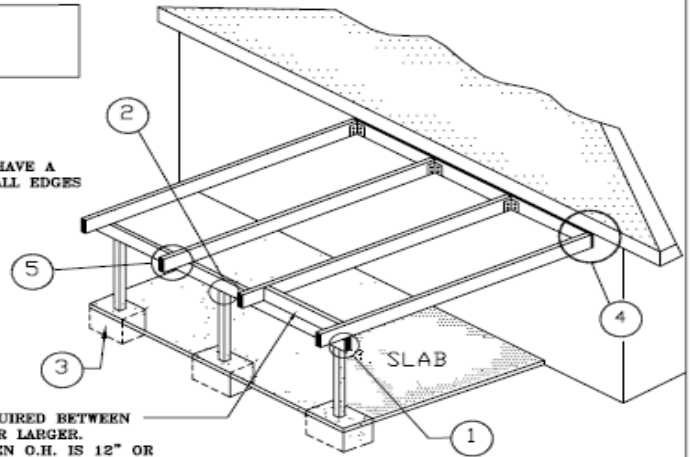

BLOCKING REQUIRED BETWEEN
JOISTS 2"X8" OR LARGER.
EXCEPTION: WHEN O.H. IS 12" OR
LESS, A 2" X FASCIA BOARD MAY
BE USED IN LIEU OF BLOCKING

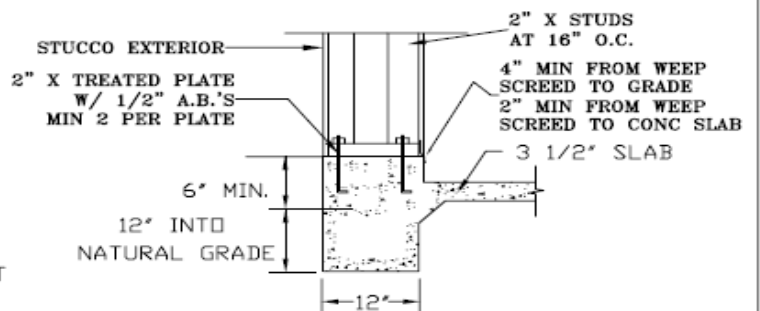

3A FOOTING DETAIL

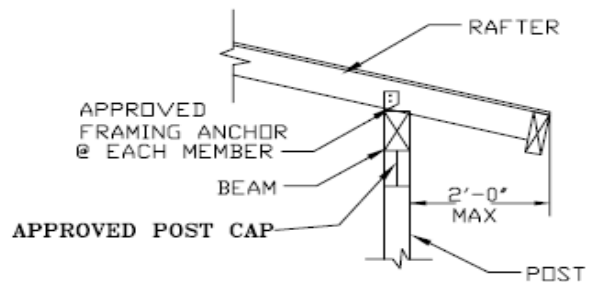

5 RAFTER TO BEAM

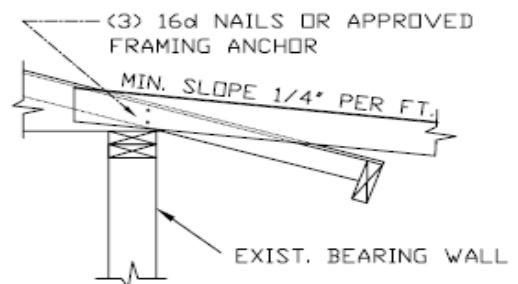

4-A ALTERNATE ATTACHMENT
FOR RAFTER ON TO BEARING WALL

Development & Engineering Services Department

11465 W. Civic Center Drive, #110, Avondale, AZ 85323 • Phone (623) 333-4000 • Fax (623) 333-0402 • TDD (623) 333-0010

www.avondaleaz.gov/developmentservices